

SPECIFICATIONS:

POWER RATING: 50 WATTS

— WHEN MOUNTED TO A HEAT SINK
CAPABLE OF MAINTAINING A CASE
TEMPERATURE AT OR BELOW 100°C.

FREQUENCY RANGE: DC TO 6 GHz

VSWR: DC TO 3 GHz AT 1.15:1 MAX.

3 GHz TO 6 GHz AT 1.25:1 MAX.

CONNECTOR: SMA MALE

FINISH: BODY: SILVER OR TRI-ALLOY PLATED

CONNECTOR: GOLD PLATED

REVISIONS			DWG. NO.	50-CT-MA	SHEET 1	REV A
ZONE	REV	DESCRIPTION	DATE	APPROVED		
	A	CONVERT TO BEC FORMAT	DMR	6-4-03	<i>ma</i>	

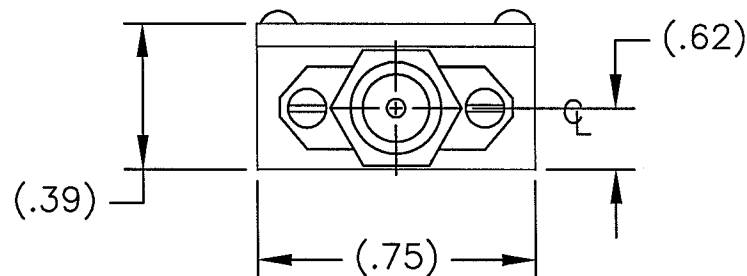
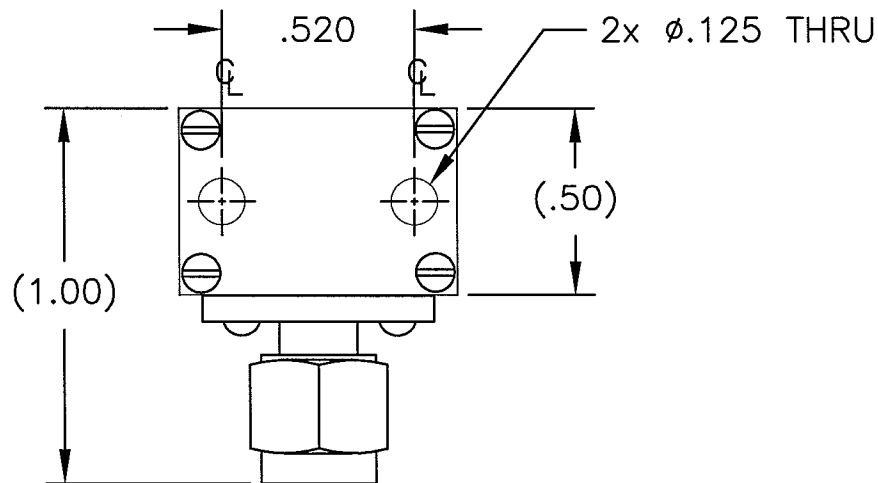

UNLESS OTHERWISE SPECIFIED
DIMENSIONS ARE IN INCHES
TOLERANCES ARE:

FRACTIONS DECIMALS ANGLES
± 1/64 .XX = ±.010 ± 30'
.XXX = ±.005

DO NOT SCALE DRAWING

MILLIMETERS
.X = ±.4
.XX = ±.12

THIS DRAWING IS THE PROPERTY OF THE BIRD ELECTRONIC CORPORATION. THE DESIGNS AND SPECIFICATIONS DISCLOSED HEREON ARE PROPRIETARY AND SHALL NOT BE REPRODUCED, NOR COPIED, NOR USED AS THE BASIS FOR THE MANUFACTURE OR SALE OF APPARATUS OR DEVICES WITHOUT THEIR EXPRESS WRITTEN CONSENT.



BIRD Electronic Corporation
Cleveland (Solon) Ohio USA

DO NOT SCALE DRAWING		APPROVALS		DATE		TITLE TERMINATION, CONDUCTION COOLED SMA MALE, 50W				
MATERIAL		DRAWN D.M.RINK		6-4-03						
FINISH		CHECKED				SIZE	FSCM NO.	DWG. NO.		REV
		APPROVED MARKV		6-19-03		A	70998	50-CT-MA		A
				AUTOCAD		SCALE 1:1		COMM CODE LD1		SHEET 1 OF 1